



# Changing your Online Notebook Password

Welcome to Study Buddy! In order to log into your online notebook, your password was preset to your last name. To maintain security in your notebook, please follow the steps outlined below to change your password.

## I. Log in to Study Buddy

On the study buddy login page, enter your registered email address and your last name (omitting any spaces) for your password.

**Study Buddy Login**

All tutees, tutors, teachers and parents login to Study Buddy online notebooks here:

Email Address

Password

[Log In](#)

Students will automatically enter their online notebook. Tutors need to click on “Go to your Vyewbooks” to be directed into their online notebook.

**Start Tutoring:**  
[Go to Study Buddy Live Tutoring Lobby](#)

**Submitted Questions:**  
There are no available questions for you to answer. Please check back later.

**Your VyewBooks:**  
[Go to your VyewBooks](#)

## II. Change your password under “Main Menu”

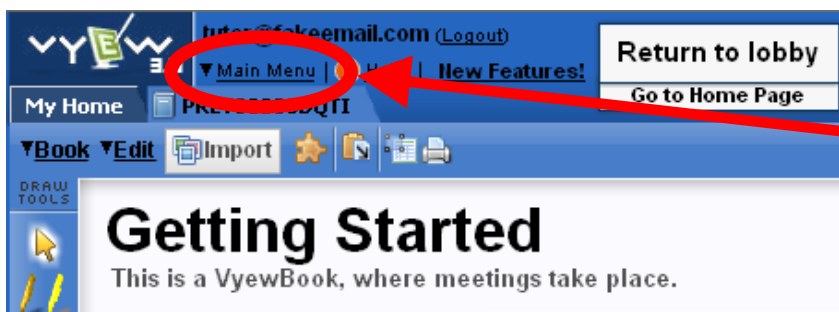

At the top of your online notebook, click on “Main Menu”.

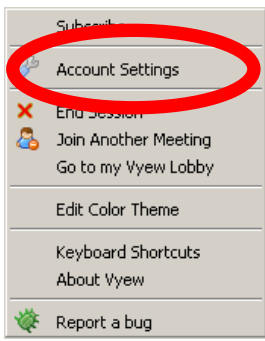

Select “*Account Settings*” from the dropdown menu. This will open the large settings window pictured below.

Click on “*Edit*” to open the User Info screen where you enter a new password.

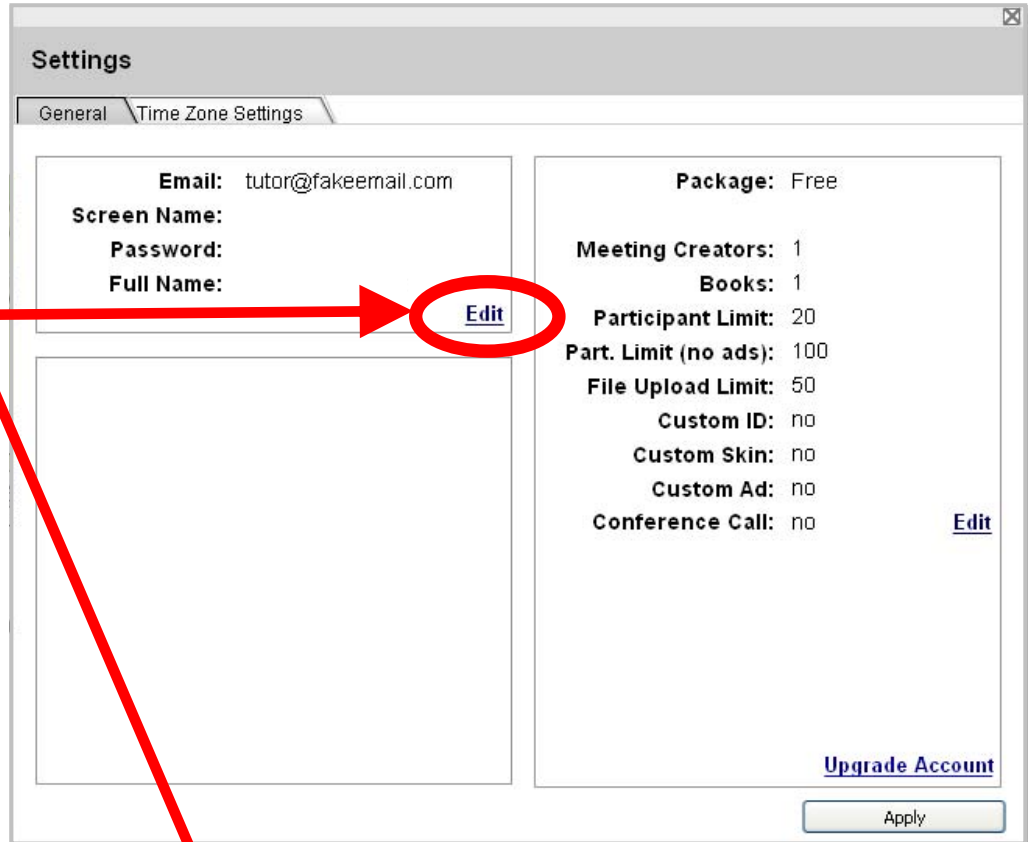

Once you click “*Submit*” your password is updated.

Remember that all passwords within Study Buddy are case sensitive!

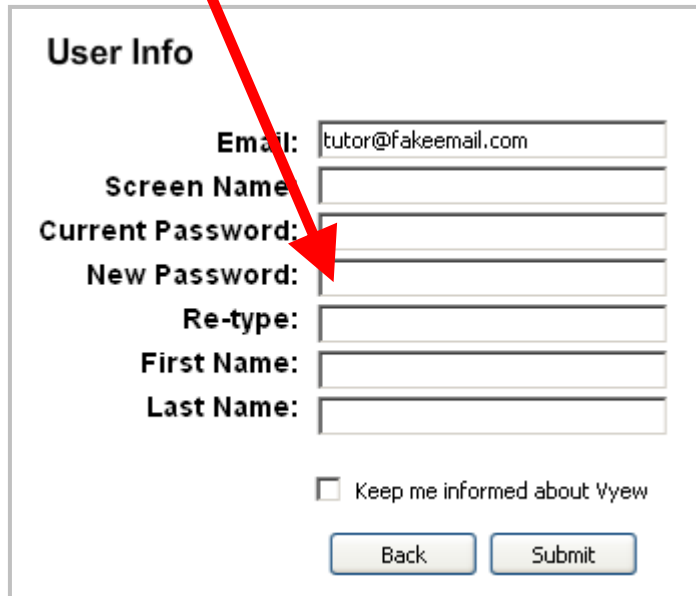

Thank you for your participation!

